

ILLUSTRATED PARTS BREAKDOWN

H-20 SERIES

SEAL KIT
 HS-01 BEFORE 1986
 HS-02 AFTER 1986

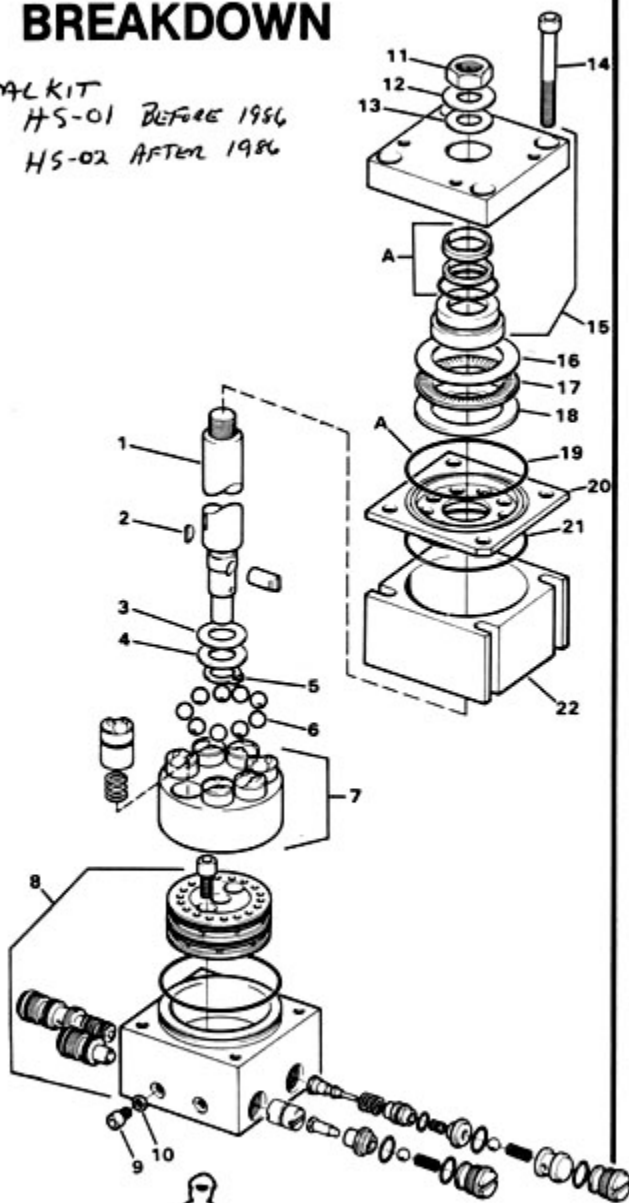

WARNING
 These Helm Units are manufactured under strict controls and testing procedures. Disassembly of item No. 8 will void any existing warranty.
 It is recommended that the unit be returned to Hynautic or the point of purchase for authorized repair and retesting.

Parts Description

Item	Description	Helm Models	Part No.	Qty.
1.	Shaft	H-21, 22	400057	1
		H-23	400117	1
		H-25	400167	1
		H-26	400167	1
2.	Key	H-21, 22	650047	1
		H-23	650027	1
		H-25	650027	1
		H-26	650027	1
3.	Washer	ALL	740078	1
4.	Bearing Race	ALL	190012	1
5.	Retaining Ring	ALL	300046	1
6.	Ball	ALL	234066	9
7.	Cyl. Barrel Assy	H-21	510080	1
		H-23	510080	1
		H-25	510080	1
		H-22, 26	510070	1
8.	Valve Body Assy †	ALL	900220	1
9.	Screw	ALL	240317	2
10.	Gasket	ALL	390028	2
11.	Nut	H-21, 22	340041	1
		H-23	270071	1
		H-25	270037	1
		H-26	270037	1
12.	Washer	H-21, 22	740011	1
13.	Washer	H-21, 22	740037	1
14.	Soc. Hd. Cap Screw	ALL	240367	4
15.	Body Assy-Front Cover	ALL	900300	1
16.	Bearing Race- thin	ALL	190004	1
17.	Bearing- thrust	ALL	190001	1
18.	Bearing Race-thick	ALL	190003	1
19.	O-Ring	ALL	211040	1
20.	Ball Cage	ALL	620018	1
21.	O-Ring	ALL	211039	2
22.	Body Spacer	ALL	900264	1
A	Seal Kit (with spare O-Rings)	ALL	HS-02	

†Note: The valve assembly is tested at Hynautic. Replacement of individual valve parts may produce valve leakage or failure.

CAUTION
 If you disassemble the entire unit, the ball cage (No. 20) must be properly aligned with the body spacer (No. 22) and valve body assembly (No. 8). Failure to do so will result in poor pump performance. To insure proper timing: Align the notched corner of the ball cage as illustrated with the corners of the body spacer (No. 22) and valve assembly (No. 8), using as a reference the two protruding bleed screws (No. 9).



Marine Systems and Products - 1579 Barber Road, Sarasota, FL 34240 Tel. 941-379-0500 FAX 941-379-0496

© 1992 Ino Industries, Inc., Hynautic Operations, Morse Controls Division

